

INDUSTRIAL SPACE FOR SUBLEASE GOWEN BUSINESS CENTER 1

1065 EXCHANGE STREET • BOISE, IDAHO 83702



PROPERTY INFORMATION:

Submarket:	Southeast	Power:	3 Phase
Available:	Immediately	Sprinklered:	0.30 /3,960
Bldg Type:	Ind Flex WH	Zoning:	M-1D
Bldg Size:	57,177 SF	Parking:	Ample
Clear Height:	20'	Lease Type:	NNN
Grade Level:	Possible	Est. NNN:	\$0.18/SF
Dock Door:	Yes		

AVAILABLE SPACE:

SPACE:	RSF:	RATE/SF:	RENT/Mo:
1147	Office 577 SF		
	Whse 8,500 SF		
	Total 9,077 SF	\$0.45	\$4,080.15 + NNN

[CLICK TO VIEW LEASE FLYER](#)

CONTACT:

Dan Minnaert, SIOR, CCIM

Ph: 208.947.0845

dan@tokcommercial.com

Devin Pierce, SIOR

Ph: 208.947.0850

devin@tokcommercial.com

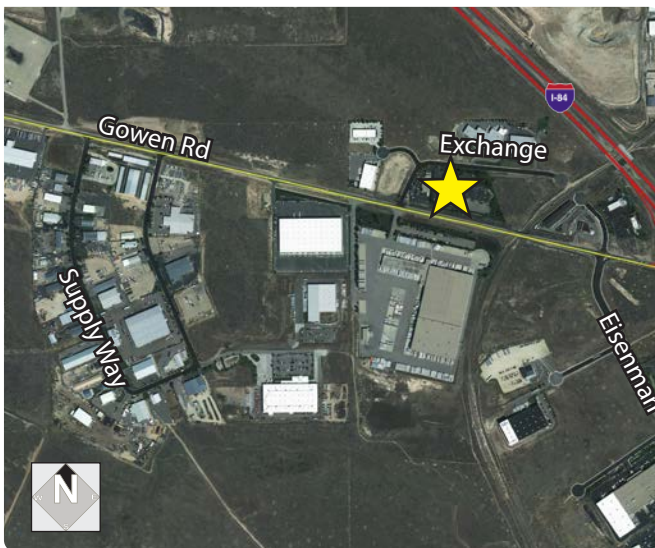

LISTING COMMENTS:

Prime industrial park location with easy access to I-84 and major thoroughfares.

Flexible and attractive space with freeway visibility.

Grade level loading door can be easily added.

Excellent location for distribution purposes.

Climate controlled warehouse.

INDUSTRIAL SPACE FOR SUBLEASE GOWEN BUSINESS CENTER 1

1065 EXCHANGE STREET • BOISE, IDAHO 83702

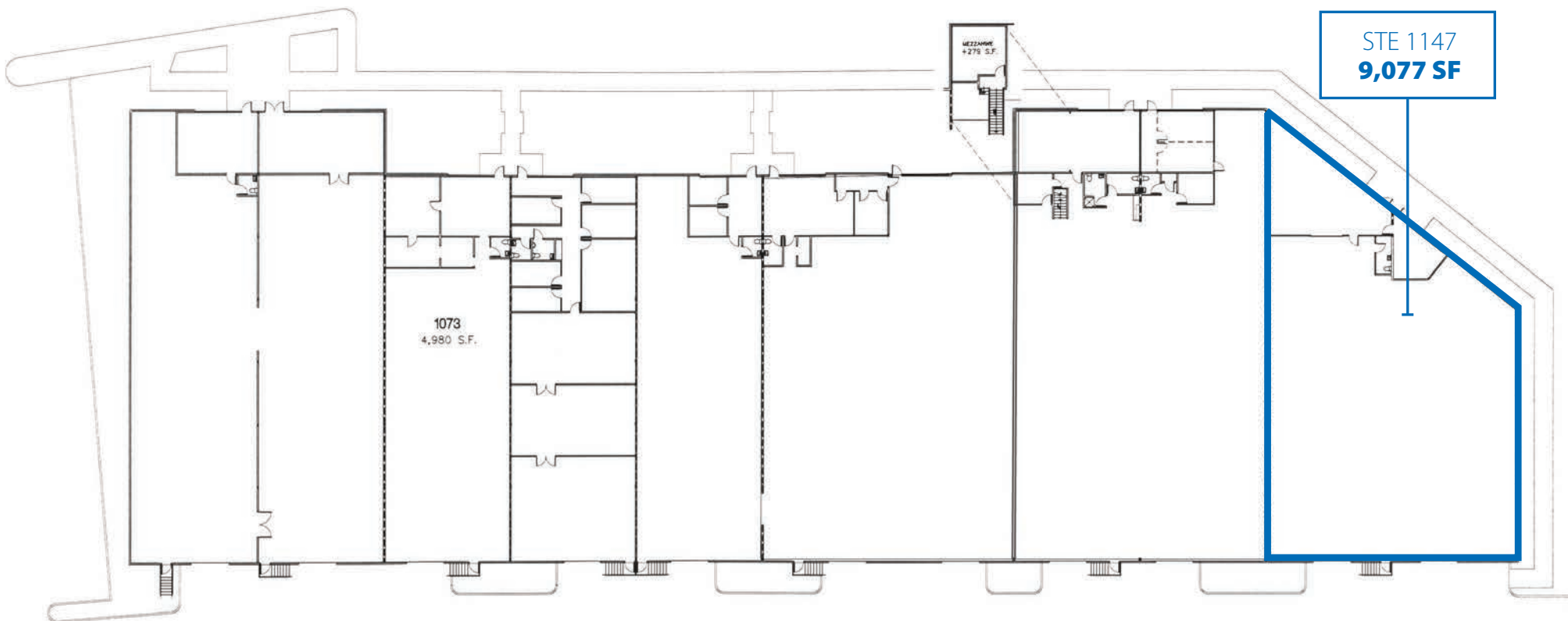

This information was obtained from sources believed reliable but cannot be guaranteed. Any opinions or estimates are used for example only.